

CIVIL LEGEND	
Ex. COMBINED SEWER	
Ex. WASTE WATER	
PERMITTED WASTE WATER	
WASTE WATER	
FOUL INSPECTION CHAMBER	
SOIL VENT PIPE	
BACK INLET GULLEY TRAP	
FOUL RODDING EYE	
ACC DRAIN	
Ex. SURFACE WATER	
SURFACE WATER	
SURFACE ACCESS JUNCTION	
RAINWATER PIPE	
ROAD GULLEY	
SURFACE RODDING EYE	
GULLEY TRAP	
Ex. WATERMAIN	
IM APPROVED HDPE WATERMAIN DIAMETER AS PER PLAN	
SLUICE VALVE	
WASHOUT HYDRANT	
AIR VALVE	
FIRE HYDRANT	
100mm Ø HDPE WATER MAIN CONNECTION & BOUNDARY BOX	
TRUST BLOCK	
BULK METER	
DENOTES ROADS & SERVICES CONTAINED WITHIN, IN CHARGE OF CCC	
WAYLEAVE REQUIRED OVER BLOCK 10 LAND	

- NOTES**
1. ALL LEVELS IN METRES ABOVE ORDNANCE DATUM.
  2. ALL DRAINAGE DETAILS TO BE SUBMITTED AND AGREED WITH CORK COUNTY COUNCIL PRIOR TO COMMENCEMENT OF WORKS.
  3. CONTRACTOR TO TRACE ALL SERVICES WITHIN SITE BOUNDARY TO ASCERTAIN OUTFALL LOCATIONS OF ALL DRAIN RUNS & LOCATION OF ALL LIVE SERVICES PRIOR TO COMMENCEMENT OF SITE CLEARANCE WORKS.
  4. CONTRACTOR TO AGREE ANY DIVERSIONS WHERE NECESSARY WITH CONSULTANTS / LOCAL COUNTY COUNCIL.
  5. INVERT & COVER LEVELS ARE INDICATIVE ONLY. DRAIN RUNS & LEVELS ARE TO BE AGREED WITH SOUTH CORK CITY COUNCIL PRIOR TO COMMENCEMENT OF WORKS.
  6. PIPES LAID IN ROADWAYS TO BE ENCASED IN 150mm CONCRETE WHERE COVER TO PIPE IS LESS THAN 1.2m. PIPES LAID IN OPEN SPACES TO BE ENCASED IN 150mm CONCRETE WHERE COVER TO PIPE IS LESS THAN 0.9m.
  7. ALL PIPE RUNS CROSSING PUBLIC ROADWAYS OR ROADS TO BE TAKEN IN CHARGE TO BE S&S CONCRETE PIPES TO 150 OR SIMILAR APPROVED.
  8. RW OUTLETS AND AJ'S TO BE PROVIDED IN ACCORDANCE WITH DOWNPIPE LOCATIONS INDICATED ON ARCHITECT'S DRAWING. CONTRACTOR TO ENSURE FULL COORDINATION WITH ALL OTHER UNDERGROUND SERVICES PRIOR TO COMMENCEMENT OF WORKS.
  9. ALL MANHOLE COVERS (IN PAVED / PAVEMENT AREAS) TO BE ABLE TO ACCOMMODATE FINISHES TO MATCH SURROUNDING AREA.
  10. RW OUTLETS, AJ, GULLY (AND MANHOLE) LOCATIONS ARE SUBJECT TO APPROVAL PRIOR TO INSTALLATION. 1 No. GULLY REQUIRED FOR EVERY 200m<sup>2</sup> HARD STANDING MIN. ALL UNDERGROUND PIPE WORK TO BE KEPT A MINIMUM OF 3.0m AWAY FROM BUILDING FOUNDATIONS. WHERE THIS ISNT POSSIBLE THE FOUNDATION LEVEL OF THE BUILDING SHALL BE LOWERED TO THE ADJACENT PIPE INVERT LEVEL WITH LEAN MIX.

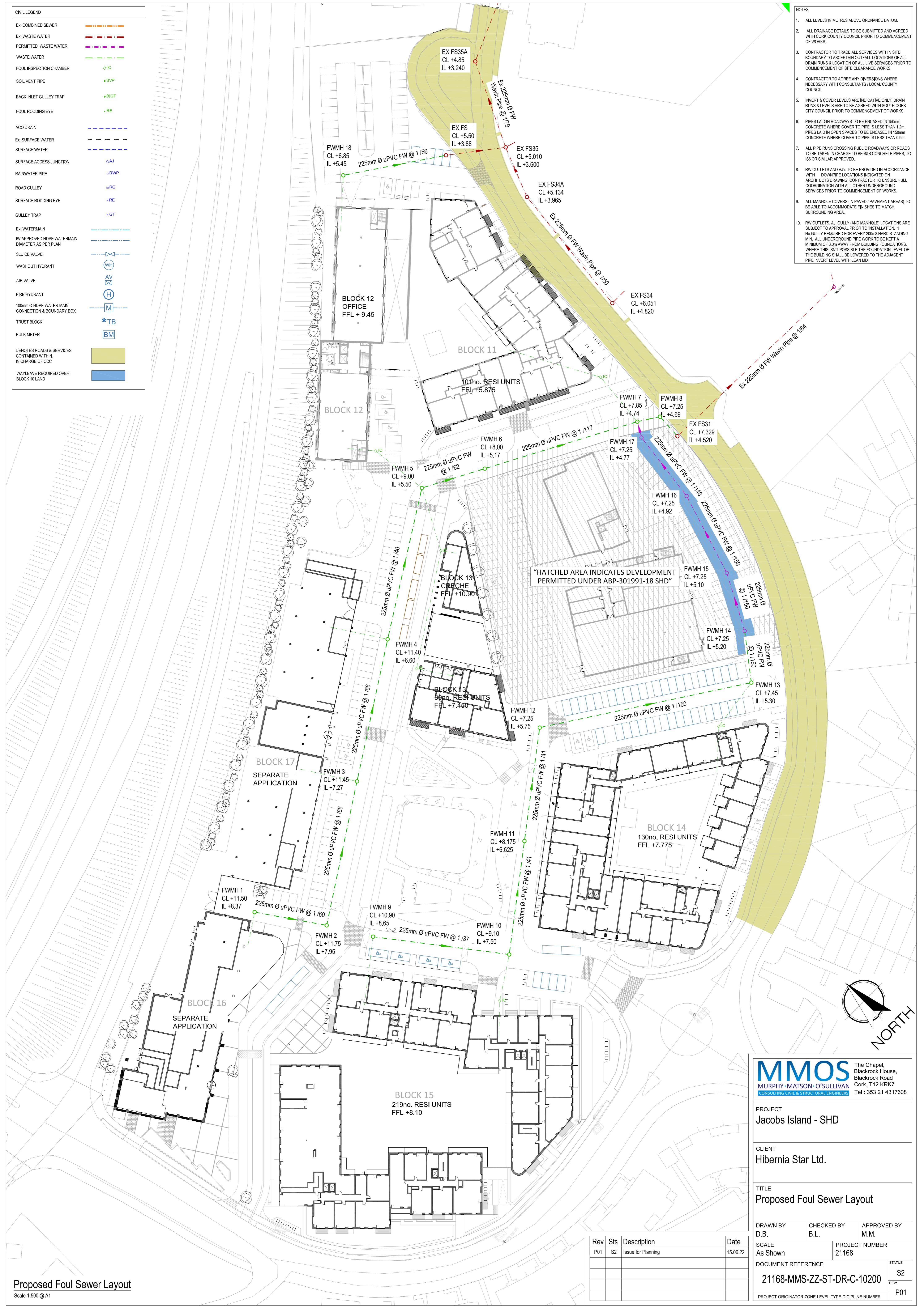

"HATCHED AREA INDICATES DEVELOPMENT PERMITTED UNDER ABP-301991-18 SHD"

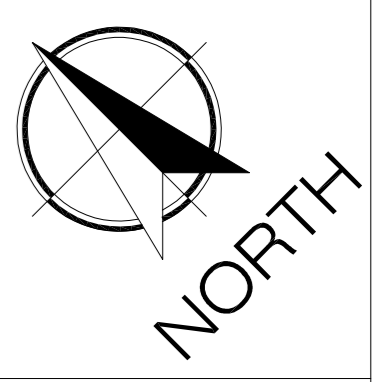

**MMOS** The Chapel, Blackrock House, Blackrock Road, Cork, T12 KRK7  
 MURPHY - MATSON - O'SULLIVAN CONSULTING CIVIL & STRUCTURAL ENGINEERS Tel: 353 21 4317608

PROJECT <b>Jacobs Island - SHD</b>	
CLIENT <b>Hibernia Star Ltd.</b>	
TITLE <b>Proposed Foul Sewer Layout</b>	
DRAWN BY D.B.	CHECKED BY B.L.
APPROVED BY M.M.	PROJECT NUMBER 21168
DOCUMENT REFERENCE <b>21168-MMS-ZZ-ST-DR-C-10200</b>	
PROJECT-ORIGINATOR-ZONE-LEVEL-TYPE-DIAGRAM-NUMBER	
STATUS S2	REV P01

Rev	Sts	Description	Date
P01	S2	Issue for Planning	15.06.22

**Proposed Foul Sewer Layout**  
 Scale 1:500 @ A1